

Data Sheet

DIN 11851 Hygienic Union & 11852 Fittings

The DIN 11851 union is widely used throughout Europe and the Middle East and incorporates a round slotted nut and D Section seal, as standard. The union is manufactured to suit Imperial tube sizes from 1" to 4" and also to suit DIN 11850 metric tube from 10mm to 200mm, as standard. Two seal designs are offered for the union, namely the flush fitting and crevice free lipped seal and the more common, D section seal. A thicker section of seal is also available for high pressure applications and to compensate for minor pipeline misalignment.

The standard seal material is Nitrile/Perbunan (Buna) and is generally blue or grey in colour, while alternatives in Viton®, EPDM, PTFE and translucent silicone are also available.

The male features an inverted cone face that carries the seal, whilst the liner is similarly conical with a flat face to effect a clean hygienic joint.

Working Pressure Range, (Fully Forged Unions):

DN 10 - DN 40	Max. Working Pressure 40 Bar @ 20°C
DN 50 - DN 100	Max. Working Pressure 25 Bar @ 20°C
DN 125 - DN 150	Max. Working Pressure 16 Bar @ 20°C

Size Ranges:

Imperial:	1" to 4"
Metric:	10mm to 200mm

Seal Design:

- D Section - Unlipped
- D Section - Unlipped (Oversized)
- P Section - Lipped



Accessories:

- Blank Nuts and Chains
- Reducing Lines
- Cone Strainers
- Bends, Tees and Reducers
- EPDM, Nitrile, Viton®, PTFE & PTFE Envelope
- C Spanner
- Pipe Clips and U Bolts
- Fabricated Bends, Tees and Manifolds
- Filters, Screens and Sampling Equipment

Full range of Butterfly Valves, Ball Valves, Pressure Relief and Non-Return

Associated standards:

- DIN 11853 - Aseptic Union Screwed
- DIN 11852 - Hygienic Fittings, Metric
- DIN 11850 - Hygienic Tube, Metric
- DIN 11864-1 - Aseptic Union Screwed
- DIN 11864-2 - Aseptic Union Flanged
- DIN 11864-3 - Aseptic Union Tri-Clamp
- DIN11866 - Pharmaceutical Tube, Metric
- ASME BPE - Pharmaceutical Tube, Imperial
- ISO 2037 - Stainless Steel Tubes for the Food Industry
- ASTM A270 - Stainless Steel Tube for Sanitary, Dairy and Food Industries
- ASTM A312 - Stainless Steel Pipe for High Temperature and General uses
- ISO 1127 - Stainless Steel Tubes
- ISO 2851 - Stainless Steel Bends and Tees for the Food Industry
- SMS 3008 - Stainless Steel Tubes
- SMS 3017 - Stainless Steel Tubes

Data Sheet

DIN 11851 Hygienic Union – Imperial

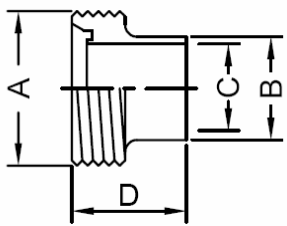
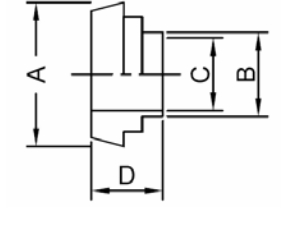
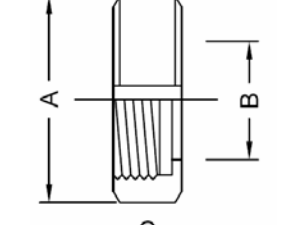
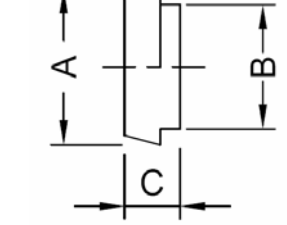
DIN 11851 Hygienic Union – Imperial						
<p>DIN 11851 Male Part – Welding, 316</p> 	Size	A	B	C	D	Part No
	1"	52	25.4	22.2	29	6061-A026
	1.1/4"	58	32.0	29.2	32	6061-A032
	1.1/2"	65	38.1	34.9	33	6061-A038
	2"	78	50.8	47.6	35	6061-A051
	2.1/2"	95	63.5	60.3	40	6061-A064
	3"/ DN 75	104	76.2	73.0	40	6061-A075
	3"/DN 80	110	76.2	73.0	45	6061-A076
	4"	130	101.6	97.6	54	6061-A102
	<p>DIN 11851 Liner – Welding, 316</p> 	Size	A	B	C	D
1"		44	25.4	22.2	22	6063-A026
1.1/4"		50	32.0	29.2	25	6063-A032
1.1/2"		56	38.1	34.9	26	6063-A038
2"		69	50.8	47.6	28	6063-A051
2.1/2"		86	63.5	60.3	32	6063-A064
3"/ DN 75		93	76.2	73.0	32	6063-A075
3"/DN 80		100	76.2	73.0	37	6063-A076
4"		121	101.6	97.6	44	6063-A102
<p>DIN 11851 Nut – Slotted, 304</p> 		Size	A	B	C	D
	1"	63	36	21		6064-C025
	1.1/4"	70	42	21		6064-C032
	1.1/2"	78	49	21		6064-C040
	2"	92	62	22		6064-C050
	2.1/2"	112	80	25		6064-C065
	3"/ DN 75	120	86.5	26		6064-C075
	3" / DN 80	127	94	29		6064-C080
	4"	148	115	31		6064-C100
	<p>DIN 11851 Blank Liner, 316</p> 	Size	A	B	C	D
1"		44	35	13.5		6066-A025
1.1/4"		50	41	13.5		6066-A032
1.1/2"		56	48	13.5		6066-A040
2"		69	61	14.5		6066-A050
2.1/2"		86	79	16.5		6066-A065
3"/ DN 75		93	75	16.5		6066-A075
3" / DN 80		100	93	16.5		6066-A080
4"		121	114	20.5		6066-A102

Data Sheet

DIN 11851 Hygienic Union – Metric

DIN 11851 Hygienic Union – Metric						
<p>DIN 11851 Male Part – Welding, 316 Long</p> 	Size	A	B	C	D	Part No
	10	28	13	10	21	6061-A010
	15	34	19	16	21	6061-A015
	20	44	23	20	24	6061-A020
	25	52	29	26	29	6061-A025
	32	58	35	32	32	6061-A032
	40	65	41	38	33	6061-A040
	50	78	53	50	35	6061-A050
	65	95	70	66	40	6061-A065
	75	104	76	72	40	6061-A075
	80	110	85	81	45	6061-A080
	100	130	104	100	54	6061-A100
	125	160	129	125	46	6061-A125
	150	190	154	150	50	6061-A150
	<p>DIN 11851 Liner - Welding, 316, Long</p> 	Size	A	B	C	D
10		22	13	10	17	6063-A010
15		28	19	16	17	6063-A015
20		36	23	20	18	6063-A020
25		44	29	26	22	6063-A025
32		50	35	32	25	6063-A032
40		56	41	38	26	6063-A040
50		68	53	50	28	6063-A050
65		86	70	66	32	6063-A065
3"		93	76	72	32	6063-A075
80		100	85	81	37	6063-A080
100		121	104	100	44	6063-A100
125		150	129	125	34	6063-A125
150		176	154	150	37	6063-A150
<p>DIN 11851 Nut – Slotted, 304</p> 		Size	A	B	C	D
	10	38	19	18		6064-C010
	15	44	25	18		6064-C015
	20	54	31	20		6064-C020
	25	63	36	21		6064-C025
	32	70	42	21		6064-C032
	40	78	49	21		6064-C040
	50	92	62	22		6064-C050
	65	112	80	25		6064-C065
	3"	120	87	26		6064-C075
	80	127	94	30		6064-C080
	100	148	115	31		6064-C100
	125	178	138	35		6064-C125
	150	210	164	40		6064-C150

Data Sheet

DIN 11851 Hygienic Union – Metric

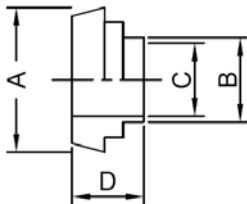
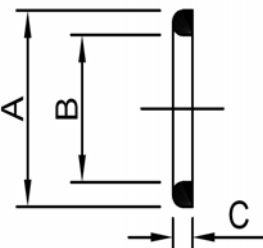
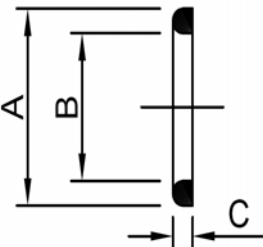
DIN Blank Liner, 316	Size	A	B	C	D	Part No	
	10	22	19	9		6063-A010	
	15	28	25	9		6063-A015	
	20	36	31	11		6063-A020	
	25	44	36	13		6063-A025	
	32	50	42	13		6063-A032	
	40	56	49	13		6063-A040	
	50	68	62	14		6063-A050	
	65	86	80	16		6063-A065	
	3"	93	86	16		6063-A075	
	80	100	94	16		6063-A080	
	100	121	115	20		6063-A100	
	125	150	138	22		6063-A125	
	150	176	184	24		6063-A150	
	DIN 11851 Seal, Nitrile	Size	A	B	C	D	Part No
	10	20	12	4.5		6034-N010	
	15	26	18	4.5		6034-N015	
	20	33	23	4.5		6034-N020	
	25	40	30	5		6034-N025	
	32	46	36	5		6034-N032	
	40	52	42	5		6034-N040	
	50	64	54	5		6034-N050	
	65	81	71	5		6034-N065	
	3"	88	78	5		6034-N075	
	80	95	85	5		6034-N080	
	100	114	104	6		6034-N100	
	125	142	130	7		6034-N125	
	150	167	155	7		6034-N150	
							Alternative materials include EPDM, Silicone, Viton, PTFE & PTFE Envelope
	DIN 11851 Seal with Lip	Size	A	B	C	D	Part No
	10	20	10.5	5		6035-N010	
	15	26	16.5	5		6035-N015	
	20	33	20.5	5		6035-N020	
	25	40	26.5	6		6035-N025	
	32	46	32.5	6		6035-N032	
	40	52	38.5	6		6035-N040	
	50	64	50.5	6		6035-N050	
	65	81	66.5	6		6035-N065	
	80	95	81.5	6		6035-N080	
	100	114	100.5	6		6035-N100	
	125	142	125	7		6035-N125	
	150	167	150	7		6035-N150	
							Alternative materials available in EPDM and Viton

Data Sheet

DIN 11851 Hygienic Union – Metric

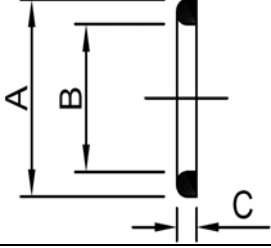
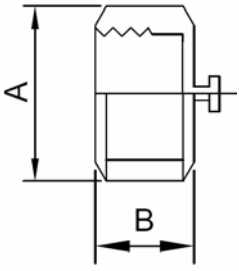
DIN 11851 Hygienic Union – Metric						
<p>DIN 11851 Seal Thick Section</p> 	Size	A	B	C	D	Part No
	20	33	23	8		6036-N020
	25	40	30	8		6036-N025
	32	46	36	8		6036-N032
	40	52	42	8		6036-N040
	50	64	54	8		6036-N050
	65	81	71	8		6036-N065
	75	88	78			
	80	95	85	8		6036-N080
	100	114	104	8		6036-N100
	125	142	130			6036-N125
	150	167	155			6036-N150
						Alternative materials available in EPDM & Viton
	<p>DIN 11851 Blank Nut – Slotted, 304</p> 	Size	A	B	C	D
10		38	18			606A-C010
15		44	18			606A-C015
20		54	20			606A-C020
25		63	21			606A-C025
32		70	21			606A-C032
40		78	21			606A-C040
50		92	22			606A-C050
65		112	25			606A-C065
3"		120	26			606A-C075
80		127	29			606A-C080
100		148	31			606A-C100
125		178	35			606A-C125
150		210	40			606A-C150
					Chains and a Disc seal are also available	

Data Sheet

DIN 11852 Welding Fittings

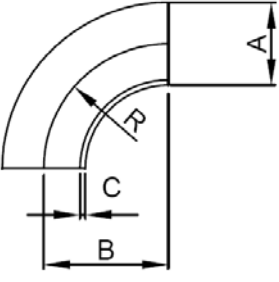
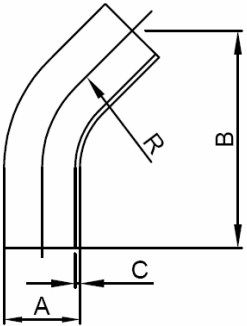
Bend DIN 11852, 90°	Size	A	B	C	R	Part No
	10	12	26	1.5	26	605C-A012
	10	13	26	1.5	26	605C-A013
	15	18	35	1.5	35	605C-A018
	15	19	35	1.5	35	605C-A018
	20	22	40	1.5	40	605C-A022
	20	23	40	1.5	40	605C-A023
	25	28	50	1.5	50	605C-A028
	25	29	50	1.5	50	605C-A029
	32	34	55	1.5	55	605C-A034
	32	35	55	1.5	55	605C-A035
	40	40	60	1.5	60	605C-A040
	40	41	60	1.5	60	605C-A041
	50	52	70	1.5	70	605C-A052
	50	53	70	1.5	70	605C-A053
	65	70	80	2.0	80	605C-A070
	80	85	90	2.0	90	605C-A085
	100	104	100	2.0	100	605C-A104
	125	129	187.5	2.0	187.5	605C-A129
	150	154	225	2.0	225	605C-A254
	200	204	300	2.0	300	605C-A204
250	254	375	2.0	375	605C-A254	
Bend DIN 11852, 45°	Size	A	B	C	R	Part No
	10	12	17	1.5	26	605E-A012
	10	13	17	1.5	26	605E-A013
	15	18	23	1.5	35	605E-A018
	15	19	23	1.5	35	605E-A019
	20	22	27	1.5	40	605E-A022
	20	23	27	1.5	40	605E-A023
	25	28	34	1.5	50	605E-A028
	25	29	34	1.5	50	605E-A029
	32	34	37	1.5	55	605E-A034
	32	35	37	1.5	55	605E-A035
	40	40	41	1.5	60	605E-A040
	40	41	41	1.5	60	605E-A041
	50	52	48	1.5	70	605E-A052
	50	53	48	1.5	70	605E-A053
	65	70	55	2.0	80	605E-A070
	80	85	62	2.0	90	605E-A085
	100	104	69	2.0	100	605E-A104
	125	129	131	2.0	187.5	605E-A129
	150	154	157	2.0	225	605E-A154
	200	204	300	2.0	300	605E-A204

Data Sheet

DIN 11852 Welding Fittings

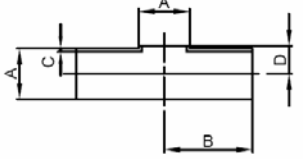
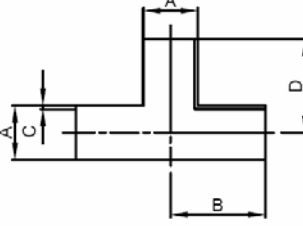
Tee Piece, Short Neck	Size	A	B	C	D	Part No
	25	28	50	1.5	16	605G-A028
	25	29	50	1.5	16	605G-A029
	32	34	55	1.5	19	605G-A034
	32	35	55	1.5	19.5	605G-A035
	40	40	60	1.5	22	605G-A040
	40	41	60	1.5	23	605G-A041
	50	52	70	1.5	29	605G-A052
	50	53	70	1.5	30	605G-A053
	65	70	80	2.0	40	605G-A070
	80	85	90	2.0	47.5	605G-A085
	100	104	100	2.0	58.5	605G-A104
	125	129	187.5	2.0	74	605G-A129
	150	154	225	2.0	90	605G-A154
	200	204	300	2.0	115	605G-A204
Tee Piece, Equal	Size	A	B	C	D	Part No
	25	28	50	1.5	50	605J-A028
	25	29	50	1.5	50	605J-A029
	32	34	55	1.5	55	605J-A034
	32	35	55	1.5	55	605J-A035
	40	40	60	1.5	60	605J-A040
	40	41	60	1.5	60	605J-A041
	50	52	70	1.5	70	605J-A052
	50	53	70	1.5	70	605J-A053
	65	70	80	2.0	80	605J-A070
	80	85	90	2.0	90	605J-A085
	100	104	100	2.0	100	605J-A104
	125	129	187.5	2.0	187.5	605J-A129
	150	154	225	2.0	225	605J-A154
	200	204	300	2.0	300	605J-A204

Data Sheet

DIN 11852 Welding Fittings

Concentric Reducer, DIN11852

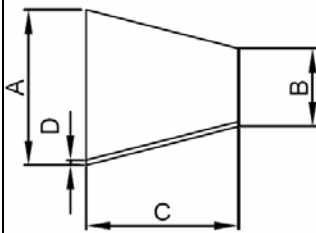

Size	A	B	C	D Wall (mm)	Part No
15-10	19	13	11	1.5	605L-A019-013
20-10	23	13	18	1.5	605L-A023-013
20-15	23	19	7	1.5	605L-A023-019
25-10	29	13	28	1.5	605L-A029-013
25-15	29	19	18	1.5	605L-A029-019
25-20	29	23	11	1.5	605L-A029-023
32-15	35	19	28	1.5	605L-A035-019
32-20	35	23	22	1.5	605L-A035-023
32-25	35	29	11	1.5	605L-A035-029
40-20	41	23	33	1.5	605L-A041-023
40-25	41	29	22	1.5	605L-A041-029
40-32	41	35	11	1.5	605L-A041-035
50-25	53	29	44	1.5	605L-A053-029
50-32	53	35	33	1.5	605L-A053-035
50-40	53	41	22	1.5	605L-A053-041
65-32	70	35	62	2.0	605L-A070-035
65-40	70	41	51	2.0	605L-A070-041
65-50	70	53	29	2.0	605L-A070-053
80-40	85	41	78	2.0	605L-A085-041
80-50	85	53	56	2.0	605L-A085-053
80-65	85	70	27	2.0	605L-A085-070
100-50	104	53	90	2.0	605L-A104-053
100-65	104	70	61	2.0	605L-A104-070
100-80	104	85	34	2.0	605L-A104-085
125-65	129	70	106	2.0	605L-A129-070
125-80	129	85	79	2.0	605L-A129-085
125-100	129	104	45	2.0	605L-A129-104
150-80	154	85	124	2.0	605L-A129-085
150-100	154	104	90	2.0	605L-A154-104
150-125	154	129	45	2.0	605L-A154-129
200-150	204	154	90	2.0	605L-A204-154

Data Sheet

DIN 11852 Welding Fittings

Eccentric Reducer, DIN11852

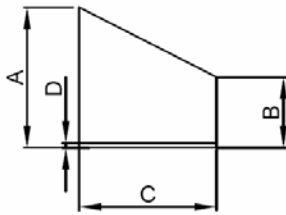

Size	A	B	C	D	Part No
15-10	19	13	16.5	1.5	605N-A019-013
20-10	23	13	27.5	1.5	605N-A023-013
20-15	23	19	11	1.5	605N-A023-019
25-10	29	13	44	1.5	605N-A029-013
25-15	29	19	27.5	1.5	605N-A029-019
25-20	29	23	16.5	1.5	605N-A029-023
32-15	35	19	44	1.5	605N-A035-019
32-20	35	23	33	1.5	605N-A035-023
32-25	35	29	16.5	1.5	605N-A035-029
40-15	41	19	60.5	1.5	605N-A041-019
40-20	41	23	49.5	1.5	605N-A041-023
40-25	41	29	33	1.5	605N-A041-029
40-32	41	35	16.5	1.5	605N-A041-035
50-25	53	29	66	1.5	605N-A053-029
50-32	53	35	49.5	1.5	605N-A053-035
50-40	53	41	33	1.5	605N-A053-041
65-40	70	41	77	2.0	605N-A070-041
65-50	70	53	44	2.0	605N-A070-053
80-50	85	53	85	2.0	605N-A085-053
80-65	85	70	41.2	2.0	605N-A085-070
100-50	104	53	137.5	2.0	605N-A104-053
100-65	104	70	93.5	2.0	605N-A104-070
100-80	104	85	52.5	2.0	605N-A104-085
125-80	129	85	121	2.0	605N-A129-085
125-100	129	104	68.5	2.0	605N-A129-104
150-100	154	104	137.5	2.0	605N-A154-104
150-125	154	129	68.5	2.0	605N-A154-129

Data Sheet

Hygienic Stainless Steel Tube

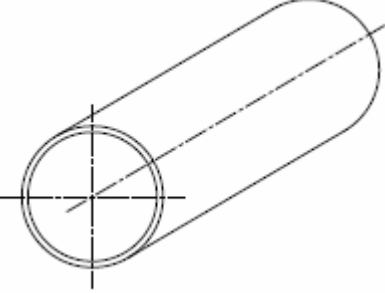
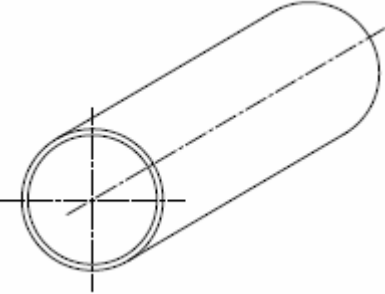
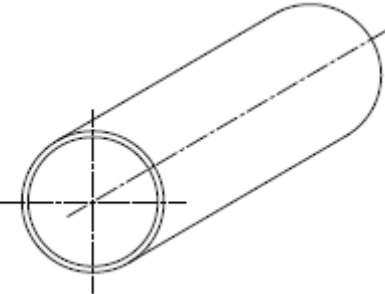
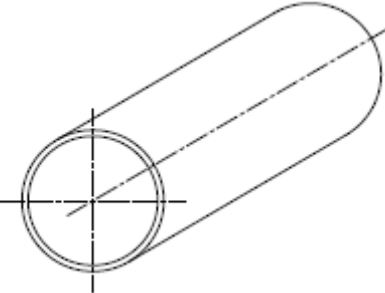
Hygienic Stainless Steel Tube				
<p>DIN 11850, Series 1</p> 	Size	OD	Wall (mm)	Part No
	10	12	1.0	
	15	18	1.0	
	20	22	1.0	
	25	28	1.0	
	32	34	1.0	
	40	40	1.0	
	50	52	1.0	
				Part No
<p>DIN 11850, Series 2</p> 	Size	OD	Wall (mm)	Part No
	10	13	1.5	
	15	19	1.5	
	20	23	1.5	
	25	29	1.5	
	32	35	1.5	
	40	41	1.5	
	50	53	1.5	
	65	70	2.0	
	80	85	2.0	
	100	104	2.0	
	125	129	2.0	
	150	154	2.0	
200	204	2.0		
				Part No
<p>DIN 11850, Series 3</p> 	Size	OD	Wall (mm)	Part No
	10	14	2.0	
	15	20	2.0	
	20	24	2.0	
	25	30	2.0	
	32	36	2.0	
	40	42	2.0	
	50	54	2.0	
				Part No
<p>DIN EN ISO 1127, Series 1</p> 	Size	OD	Wall (mm)	Part No
		17.2	1.6	
		21.3	1.6	
		26.9	1.6	
		33.7	2.0	
		42.4	2.0	
		48.2	2.0	
		60.3	2.0	
		76.1	2.3	
		88.9	2.3	
		114.3	2.6	
		139.7	2.6	
		168.3	2.6	
	219.1	2.6		
				Part No

--	--	--	--	--

Data Sheet
